



**El Camino Real
Academy**
FAMILY NEWSLETTER
August 13, 2021



WELCOME

Hello ECRA families! We hope this has been a great week for everyone. Assessment conferences have gone well and are very important for teachers to better understand their student's needs. Here are this week's updates and information. Please contact the school at 505-314-2212 in you have any questions.

IMPORTANT DATES

- August 16th: Full onsite learning options will resume for A & C (B will be remote)
- August 17: Elementary Assemblies
- August 18: Secondary Assemblies
- August 26: Open House /Title I Meeting
- August 27: August Birthday Celebrations
- August 30: NWEA Testing begins for secondary



STUDENT MEAL PICK-UP

Meal pick-ups will begin for remote students on Friday, August 20th from 1:30 to 4:30 and will continue every Friday afterwards. Each student will receive 5 breakfast and 5 lunch meals each week. Here is a [link](#) to sign up to pick up meals.



P - EBT

Here is a [link](#) to the most current information about the P-EBT benefit from the Human Services Department.





PARKING LOT SAFETY

SAFETY REMINDERS FOR STUDENT PICK UP AND DROP OFF

DROP OFF:

- Students can only be dropped off on the inside lane closest to the building
 - The outside lane will be for drive through only to keep children safe
 - There will be a sign clearly identifying which lane is for drop off and which is for passing
 - Families will need to enter through Clinton in order to get in the proper lane
 - There is a fence in between parking spaces and the drop off/pick up/drive through lanes to avoid drivers darting in and out which puts pedestrians at risk
 - Pedestrians need to use crosswalks to get to the building
 - Please keep the crosswalks clear in order to keep them accessible to pedestrians
 - The speed limit is 5 mph and please stop for pedestrians
- Please watch staff for stop and slow signs and follow their directions
 - Do not park and exit your vehicle in the passing or drop off lane
 - Please refrain from using your cell phone to help keep everyone safe
 - The parking spaces directly on the east side of the new fence are designated handicap spaces and are not to be used as a drive through lane for safety purposes

PICK UP:

- K-1 students and their elementary siblings will be picked up on Clinton on the sidewalk next to the elementary playground
- Grades 2-12 will use the front of the building for student pick up
- Please follow all the same safety guidelines named above in the drop off section

Thank you for helping keep our ECRA family safe!

< < < < < < < ISLETA BLVD > > > > > > >

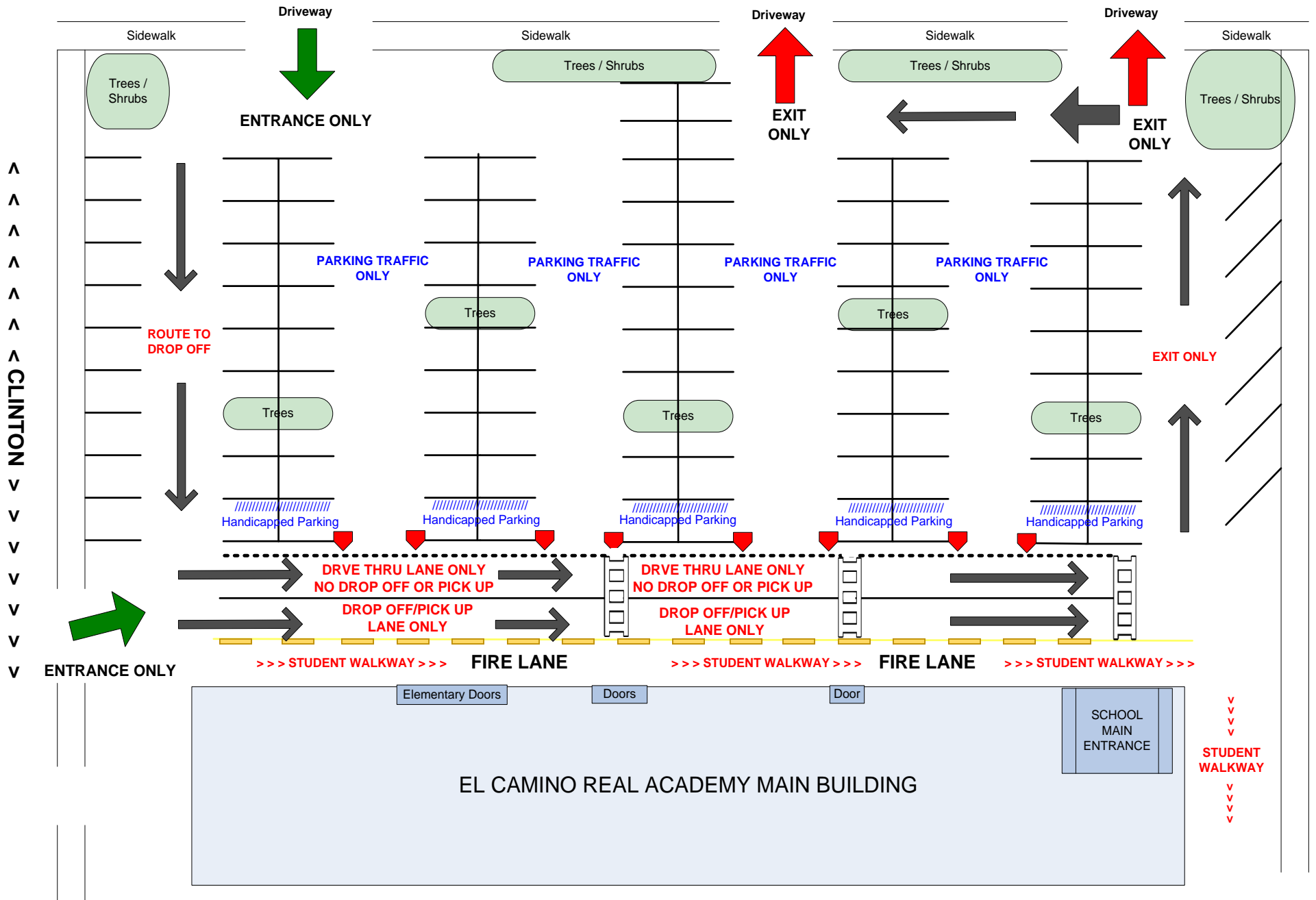

ECRA STUDENT DAILY COVID-19 QUESTIONNAIRE (if you chose in-person learning)



Each day before sending your child to school, please review the following questions regarding your child's health.

If you answer yes to any of the questions:

Please do not send your child to school. Contact a medical provider or call the COVID Hotline at 855-600-3453, then call the health office at ECRA.

Questions for ECRA Students Before They Go to School

1. Does your child currently have a temperature of over 100.4 degrees?
2. In the past 24 hours, has your child experienced:
 - Sore throat, runny nose, congestion
 - New frequent, dry cough (for students with documented chronic allergies/asthma, a change in baseline cough)
 - Shortness of breath or difficulty breathing
 - Diarrhea, vomiting
 - Loss of taste or smell
 - New onset of headache
 - Fatigue or muscle or body aches
3. Has your child recently been in close contact with anyone who has exhibited any of these symptoms?
4. Has your child recently been in contact with anyone who has tested positive for COVID-19?
5. Is anyone in the household waiting for COVID-19 test results? (Routine surveillance testing not included)

Reviewing these questions daily and making good decisions can help us prevent the spread of COVID-19.

NM STUDENT CONNECT PROGRAM



NM Student Connect can help you and your family get broadband connectivity and devices. They are working to make the process as easy as possible for students who choose to participate.

The NM Student Connect [Help Desk](#) can help eligible students' households sign up for a new federal program that pays for connectivity for eligible families, the [FCC's Emergency Broadband Benefit \(EBB\) program](#). Visit their site for more details and the up-to-date information.

The EBB provides a temporary discount of:

- Up to \$50 per month toward broadband service for eligible households
- Up to \$75 per month for eligible households located on Tribal lands.

The EBB is limited to one discounted monthly service plan per household. This valuable subsidy helps close the Homework Gap for eligible households in New Mexico. Find local internet service providers that are participating in the EBB program by searching the [ISP map](#).



If any family has a **positive case of COVID-19**, please contact Jennifer Mercer at 505-314-2212 as soon as possible. ECRA is required to report cases to the New Mexico Public Education Department. Thank you for helping us keep everyone safe!

Have a nice weekend!